

SPLASH WELL DRAIN SCUPPER

Stainless Steel 316 & Nylon & Rubber

- Stainless steel face provides an elegant appearance.
- Fits wide range of hull thickness.
- Simply press the tube at both ends to complete installation.
- The narrowed flange profile provides lower water outlet for quicker drainage.
- One-way rubber flapper for discharge.
- Caulk is required under flanges and between tubes.

Patented



INSTALLATION INSTRUCTION

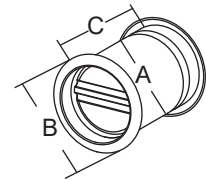
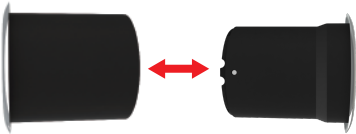

Bulk No.	A mm	B mm	C mm
0503513-8	38(1-1/2")	45(1-3/4")	25~28(1"~1-1/8")
0503513	38(1-1/2")	45(1-3/4")	28.5~32(1-1/8"~1-1/4")
0503514	38(1-1/2")	45(1-3/4")	49~73(1-15/16"~2-7/8")
0503516	38(1-1/2")	45(1-3/4")	74~100(2-3/4"~3-7/8")
0503513-V4	Rubber Flapper Only		